

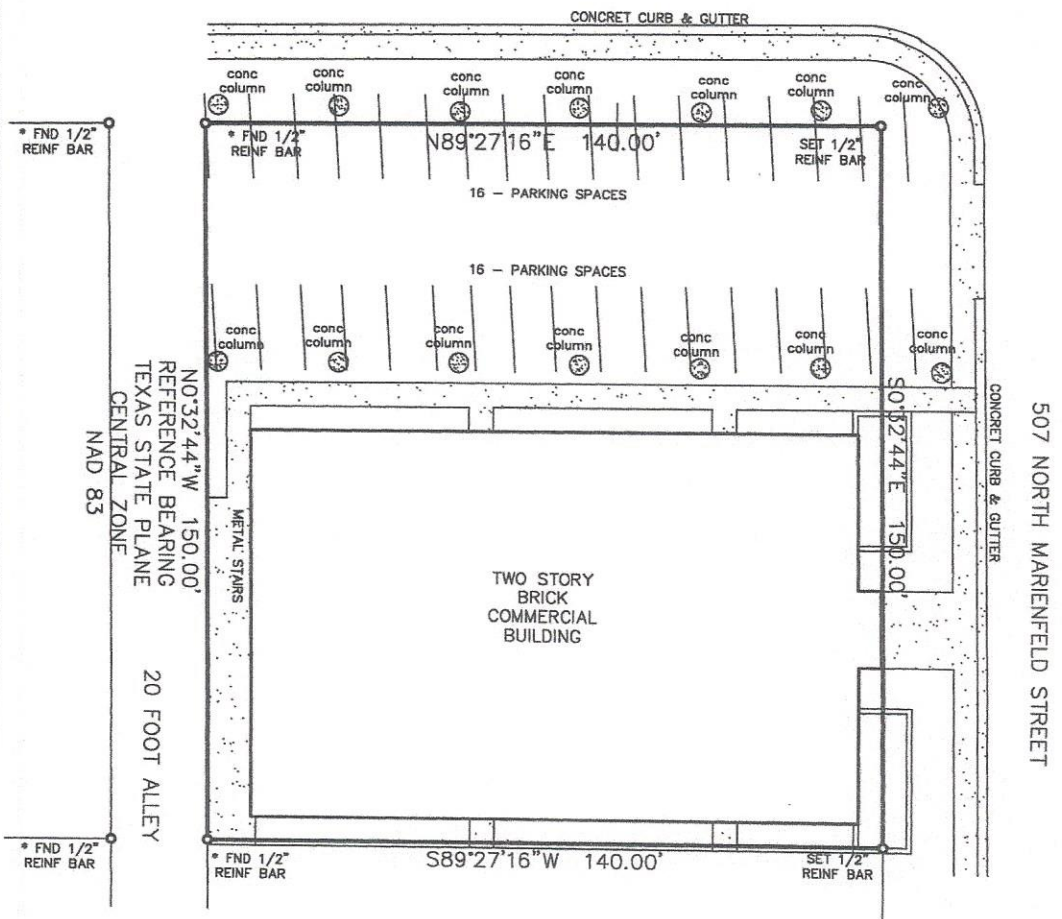

WEST MICHIGAN AVENUE



FOR FLOOD INSURANCE RATING PURPOSES: THIS PROPERTY LIES WITHIN FLOOD INSURANCE ZONE DESIGNATION "X" AS DEPICTED ON FLOOD INSURANCE RATE MAP (FIRM) NUMBER 48329-C0089F, MIDLAND COUNTY, TEXAS AND INCORPORATED AREAS EFFECTIVE DATE, SEPTEMBER 16, 2005, AS ISSUED BY THE FEDERAL EMERGENCY MANAGEMENT AGENCY (FEMA).

CENSUS TRACT NO. 102.00

TO THE LIENHOLDERS, 507 MARIENFELD BLDG LLC

(OWNER) OF THE PREMISES AND TO THE ISSUING TITLE INSURANCE UNDERWRITER: THE UNDERSIGNED DOES HEREBY CERTIFY THAT THIS SURVEY WAS MADE ON THE GROUND OF THE PROPERTY LEGALLY DESCRIBED HEREON AND THAT THERE ARE NO KNOWN DISCREPANCIES, CONFLICTS, SHORTAGES IN AREA, BOUNDARY LINE CONFLICTS, ENCOACHMENTS, OVERLAPPING OF IMPROVEMENTS, EASEMENTS OR RIGHTS-OF-WAY, EXCEPT AS SHOWN HEREON.

DATED THIS 17TH DAY OF SEPTEMBER, 2012

[Signature]
 RJ DAUM
 TEXAS RPLS 4826



SURVEY PLAT

THE NORTHEAST/4 OF
 BLOCK 38
 HOMESTEAD ADDITION

AN ADDITION TO THE CITY OF MIDLAND,
 AS PER PLAT OF RECORD IN
 VOLUME 37, PAGE 617, DEED RECORDS,
 MIDLAND COUNTY, TEXAS

SCHUMANN ENGINEERING CO., INC.

REGISTERED PROFESSIONAL LAND SURVEYORS
 LICENSED STATE LAND SURVEYORS

REGISTERED PROFESSIONAL CIVIL ENGINEERS
 TEXAS and NEW MEXICO

Civil Engineering ~ Land Surveying

408 N. PECOS STREET - P. O. BOX 504
 MIDLAND, TEXAS 79702-0504

Office (432) 684-5548
 Fax (432) 684-6973

SCALE: 1" = 30'

PROJECT: 73340JP
 JOB NO.: 73,340